

F BLOCK S4 | EVENTS SPACE

# F BLOCK S4

THE  
TRUMAN  
BREWERY

## F BLOCK S4 | EVENTS SPACE



EVENTS



FASHION  
SHOWS



EXHIBITIONS



TRADE  
SHOWS



FILMING &  
PHOTOGRAPHY



LICENSED

## ABOUT

F Block S4 comprises 4,000 sqft of event space in this former warehouse. The space benefits from one side of windows, allowing for lots of natural light and is characterised by heavy industrial piping, exposed and distressed walls, and an unpolished concrete floor. The space is one of the main access rooms for the second floor. S4 is adjoined by rooms S2, S3 and S5, to make up 30,000sqft of event space on a single floor. S4 is excellently suited for exhibitions, filming and photo shoots, music videos, networking events and trade shows.

## ACCESS

Guest Access is via a shared entrance in Ely's Yard with stairs to the second floor.

Lift access / Loading Bay Access from S3 via Ely's Yard, subject to availability.

## ADDRESS

Ely's Yard, Hanbury Street,  
London, E1 6QR

## CAPACITY

320 for the entire second floor of  
the building at any one time.

## SIZE

4,979 sqft

## LEVEL

Second floor

## CEILING HEIGHT

3.5m

F BLOCK S4 | EVENTS SPACE



OPEN WIRE  
BY  
THE  
WIRE

THIS IS  
WHAT A  
MYCOLOGIST  
LOOKS  
LIKE

## LOCATION

Located on the second floor of Truman Brewery's Events Building, F Block.

In one of London's most vibrant and energetic areas, known throughout London, the iconic Truman chimney and ever-active Estate is frequented by media, creative, fashion and tech industry denizens. The area attracts many thousands of visitors to the bustling work spaces, themed events, weekend markets, eye-popping street art, boutiques, cafes and rich diversity of restaurants.

## LIGHTING

Strip Lights.

## COMMS

The Truman Brewery's dedicated on-site service provider, TruTec Services, can easily provide support, networking, telephony and internet connectivity to this location.

## POWER

1 x 63A 3 Phase C Form Socket.  
Twin 13A Sockets throughout.

## SERVICES

3 x male toilets with urinal and 3 x female toilets.  
Water point is available subject to prior consent.

## SUPPLIERS

We recommend the use of the following teams:

EVENT PRODUCTION:

**E1 PRODUCTIONS**

INTERNET CONNECTIVITY:

**TRUTEC SERVICES**

SECURITY:

**Trusec Security Ltd.**  
Event Security Services

EVENT CLEANING SERVICES:

**The Truman Brewery**  
Event Cleaning Services





# THE TRUMAN BREWERY

A: 91 Brick Lane, London E1 6QL  
 T: 0207 770 6011  
 E: monika@trumanbrewery.com

DRAWING NAME  
**F.02.S4**

SPACE DETAILS  
**F BLOCK  
 2ND FLOOR - S4  
 BASIC PLAN**

VENUE LOCATION  
**F Block  
 15 Hanbury Street  
 London E1**

LEASE AREA (WITHIN RED BOUNDARY)  
**4979 sqft**

SCALE  
**1:120 @ A4**

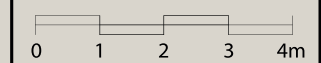

- NOTES
- SIGNIFIES CEILING STRUCTURES, MOSTLY BEAMS
  - CEILING HEIGHTS GIVEN IN MILLIMETRES ROUNDED DOWN

All measurements are approximate. Measurements in millimetres.

**DO NOT SCALE .  
 IF IN DOUBT ASK.**

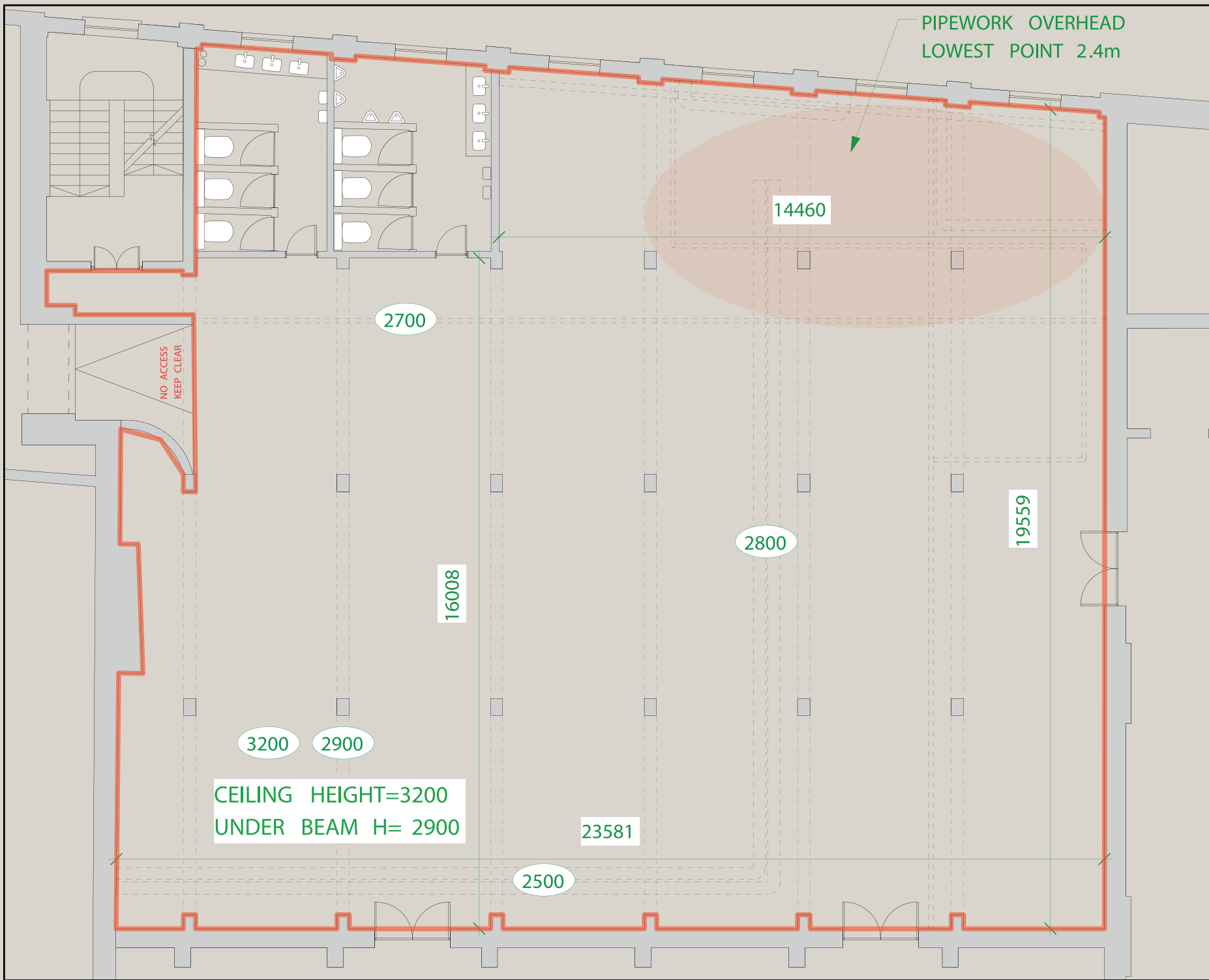





## TRANSPORT

F Block and The Truman Brewery have probably the most central Shoreditch location, and are easily reached by bus, rail, tube or on foot.

The venue benefits from close access to all forms of public transport. Liverpool Street and Shoreditch High Street stations are a short distance away, with Aldgate East within easy reach, offering fast connections across London and beyond.

**Liverpool Street Station**  
Walking distance: 10 min

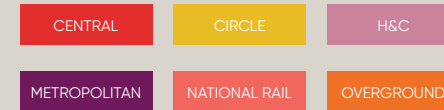

**Shoreditch High Street Station**  
Walking distance: 5 min



**Aldgate East Station**  
Walking distance: 10 min



**Whitechapel Station**  
Walking distance: 15 min



## Contact us to arrange a viewing:

### Phone

+44(0)20 7770 6001

### Email

events@trumanbrewery.com

### Drop in

The Truman Brewery Events Department,  
E y's Yard,  
15 Hanbury Street,  
London E1 6QR